

Self cleaning allround seal
Conical spring rotating
Massive seal rings
Food and pharmaceutical industry

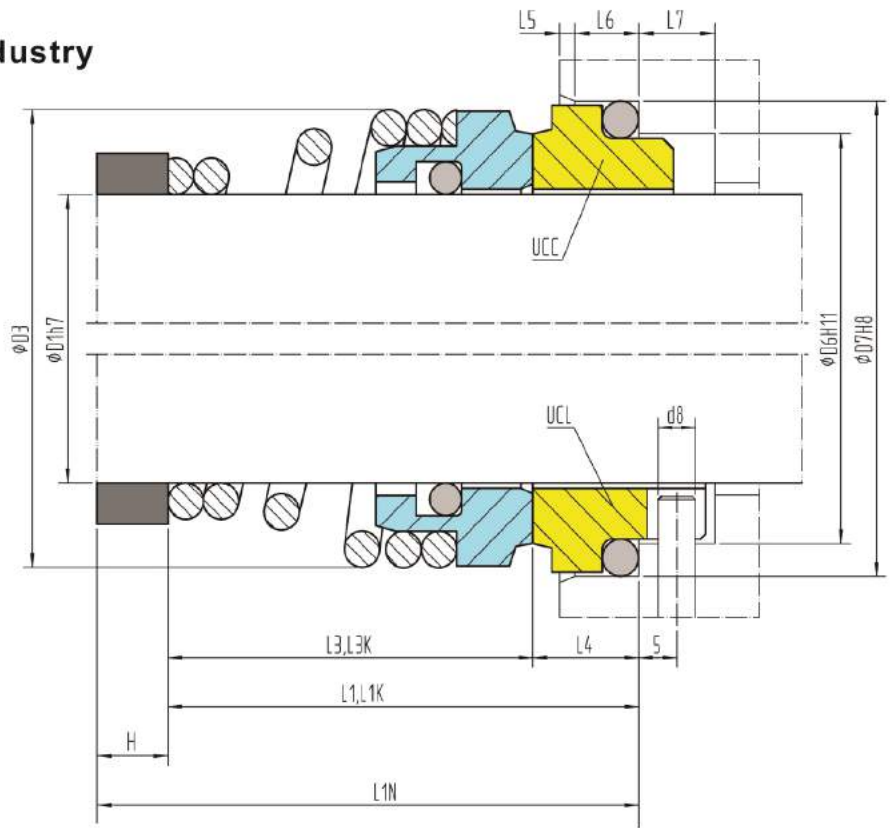

Operating limits:
 (look at working conditions page 112)

$p \leq$	16 bar
$t =$	-35 + 180°C
$v \leq$	15 m/s

Materials:

Rotary: Q, U, V
 Stationary: A, B, Q
 Rubber parts: P, E, V, K

$L1 = L3 + L4$
 $L1K = L3K + L4$
 $L1N = L3 + H + L4$

EN 12756 (DIN 24960)													UCC	UCL
D1	D6	D7	D3	L1K	L3K	L1N	L1	L3	L4	L6	L5	H	D8	L7
10	17	21	22	32.5	25.5	40	22	15	7	4	1.5	18	3	8.5
12	19	23	24	32.5	25.5	40	25	18	7	4	1.5	15	3	8.5
14	21	25	26	35	28	40	29	22	7	4	1.5	11	3	8.5
16	23	27	28	35	28	40	30	23	7	4	1.5	10	3	8.5
18	27	33	33	37.5	27.5	45	34	24	10	5	2	11	3	9
20	29	35	35	37.5	27.5	45	35	25	10	5	2	10	3	9
22	31	37	37	37.5	27.5	45	35	25	10	5	2	10	3	9
24	33	39	39	40	30	50	37	27	10	5	2	13	3	9
25	34	40	41	40	30	50	37	27	10	5	2	13	3	9
28	37	43	44	42.5	32.5	50	39	29	10	5	2	11	3	9
30	39	45	46	42.5	32.5	50	40	30	10	5	2	10	3	9
32	42	48	48	42.5	32.5	55	40	30	10	5	2	15	3	9
33	42	48	50	42.5	32.5	55	49	39	10	5	2	6	3	9
35	44	50	52	42.5	32.5	55	49	39	10	5	2	6	3	9
38	49	56	56	45	32	55	55	42	13	6	2	—	4	9
40	51	58	58	45	32	55	55	42	13	6	2	—	4	9
43	54	61	62	45	32	60	60	47	13	6	2	—	4	9
45	56	63	64	45	32	60	60	47	13	6	2	—	4	9
48	59	66	67	45	32	60	60	47	13	6	2	—	4	9
50	62	70	69	47.5	33.5	60	60	46	14	6	2.5	—	4	9
53	65	73	72	47.5	33.5	70	70	56	14	6	2.5	—	4	9
55	67	75	75	47.5	33.5	70	70	56	14	6	2.5	—	4	9
58	70	78	80	52.5	38.5	70	70	56	14	6	2.5	—	4	9
60	72	80	82	52.5	38.5	70	70	56	14	6	2.5	—	4	9
63	75	83	85	52.5	38.5	70	70	56	14	6	2.5	—	4	9
65	77	85	87	52.5	38.5	80	80	66	14	6	2.5	—	4	9
68	81	90	91	52.5	36.5	80	80	64	16	7	2.5	—	4	9
70	83	92	93	60	44	80	80	64	16	7	2.5	—	4	9
75	88	97	101	60	44	80	80	64	16	7	2.5	—	4	9
80	95	105	106	60	42	90	90	72	18	7	3	—	4	9
85	100	110	115	60	42	90	90	72	18	7	3	—	4	9
90	105	115	120	65	42	90	90	72	18	7	3	—	4	9
95	110	120	—	65	42	90	90	72	18	7	3	—	4	9
100	115	125	—	65	42	90	90	72	18	7	3	—	4	9

Spacer ring is not included in the delivery of the mechanical seal.

Shipping and industrial seal Cylindrical spring rotating Massive or shrunk seal rings

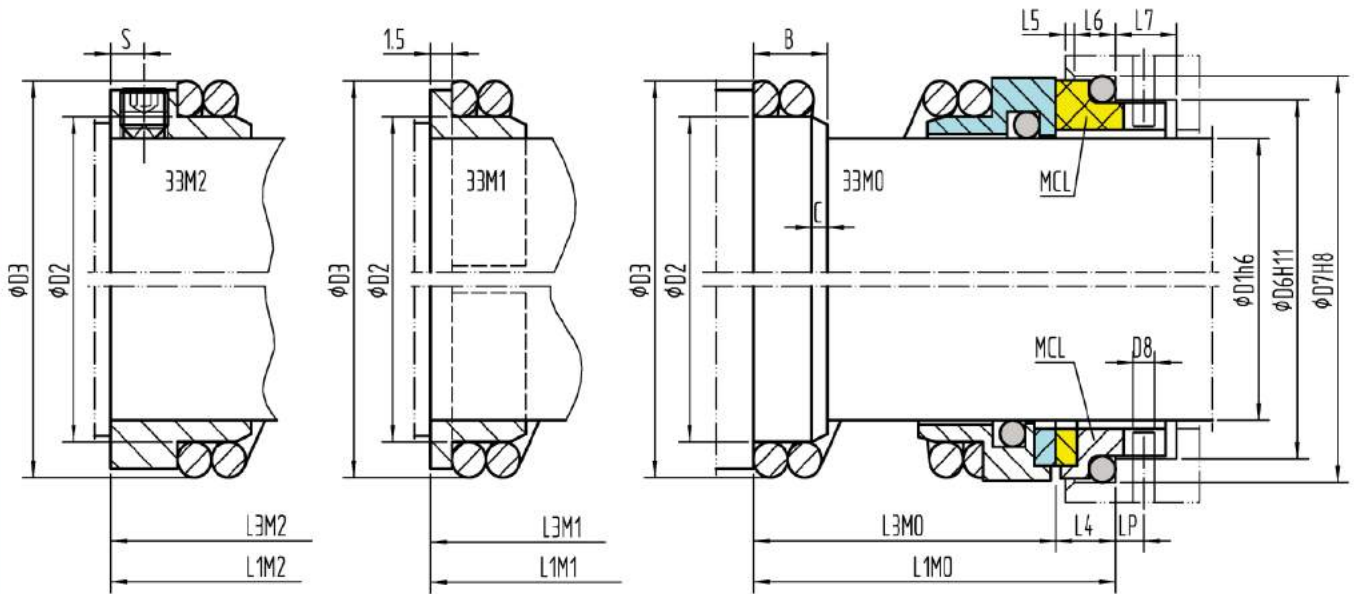

Materials:

Rotary: A, B, Q

Stationary: Q, U, V

Rubber parts: P, E, V, K, M

Operating limits:

(look at working conditions page 112)

33M0-33M1-33M2
$p \leq 16$ bar
$t = -35 \div 140^\circ\text{C}$ (180°C)
$v \leq 15$ m/s

