

Very simple mass-produced seal
Short fitting length
Low pressure range
Independent of rotation

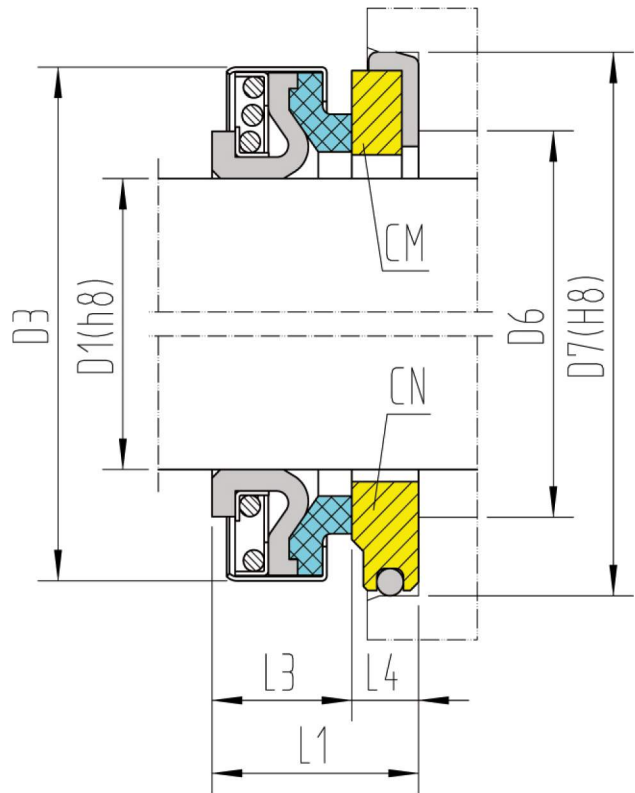

Operating limits:
 (look at working conditions page 112)

$p \leq$	5 bar
$t =$	$-20 \div 100^\circ\text{C}$
$v \leq$	10 m/s

Materials:
 Rotary: A, B, Q, U
 Stationary: H, Q, U, V
 Rubber parts: P, E, V

Special fitting dimensions

Special fitting dimensions							CM	CN
D1	D3	D6	D7	L1	L3	L4		
6	18	8	22	12	8	4		
8	20/24	10	22/26	16.5	11	5.5		
10	24	12	26	19	11	8		
11	24	13	26	19	11	8		
12	24	14	26	19/16,5	11	8/5,5		
12	24	14	26	21/18,5	13	8/5,5		
13	24	15	26	21	13	8		
14	32	16	29,5/38	21	13	8		
15	32/35	17	29,5/38	21	13	8		
16	32/35	18	29,5/38	21	13	8		
17	39	19	42	21	13	8		
18	39	20	42	21	13	8		
19	39	21	42	21	13	8		
20	39/42	22	42/45	21/23	13	8/10		
22	42	24	45	23	13	10		
23	47	25	50	24	14	10		
24	47	26	50	24	14	10		
25	42/47	27	50	24	14	10		
28	54	31	57	25	15	10		
30	54	33	57	25	15	10		
32	54	35	57	25	15	10		
35	60	38	63	26	16	10		
38	65	41	68	29	17	12		
40	65	43	68	29	17	12		
45	70	48	73	32	20	12		
50	85	53	88	38/39.5	23/24.5	15		
55	85	53	88	39	24	15		
60	105	65	110	45	30	15		
65	105	70	110	45	30	15		
70	105	75	110	47	32	15		

Simple single seal
 Short fitting length
 Low pressure range
 No torque on the bellow
 Independent of rotation

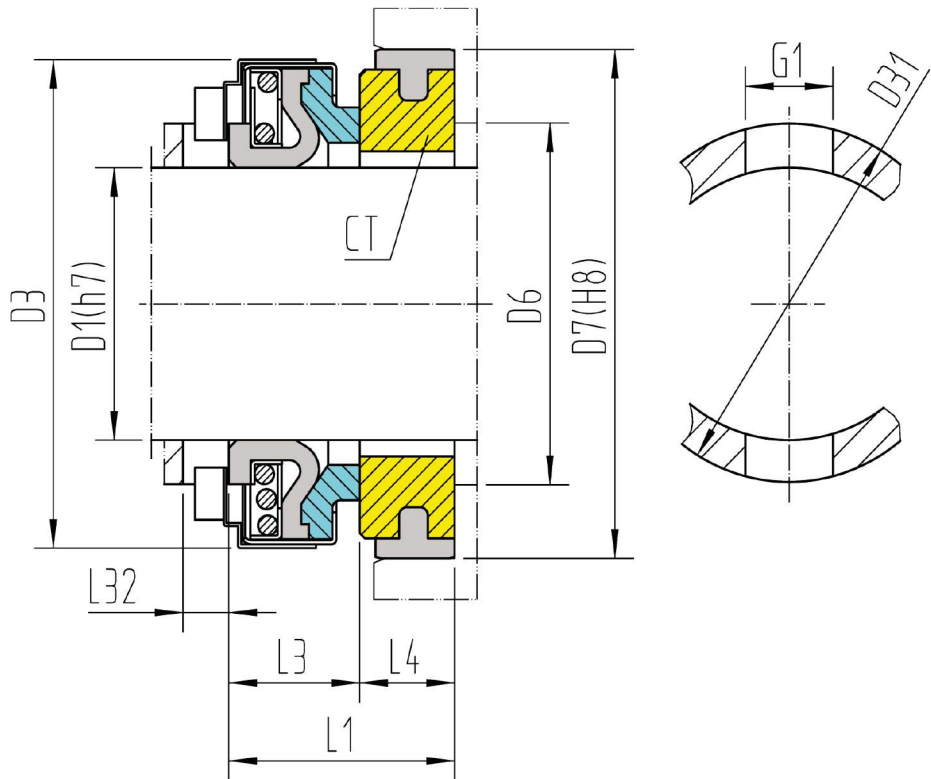

Materials:

Rotary: A, B, Q, U
 Stationary: H, Q, U, V
 Rubber parts: P, E, V

Operating limits:

(look at working conditions page 112)

p ≤	5 bar
t =	-20 ÷ 100°C
v ≤	10 m/s

Special fitting dimensions

CT

D1	D3	D6	D7	L32	L1	L3	L4	D31	G1
8	24	10	22/26	3.5	16.5	11	5.5	18	6
10	24	12	26	4	19.8	11.8	8	20	7.5
12	24	14	26	4	20,8/18,3	12.8	8/5,5	24	8
14	32	16	29,5/38	4	20.8	12.8	8	28	10
15	35	17	29,5/38	4	20.8	12.8	8	28	10
16	35	18	29,5/38	4	20.8	12.8	8	28	10
17	39	19	42	4	20.8	12.8	8	32	10
18	39	20	42	4	20.8	12.8	8	32	10
19	39	21	42	4	20.8	12.8	8	34	12
20	42	22	42/45	4	20,8/22,8	12.8	8/10.	34	12
22	42	24	45	4	22.8	12.8	10	34	12
23	47	25	50	6	23.5	13.5	10	40	12
24	47	26	50	6	23.5	13.5	10	40	12
25	47	27	50	6	23.5	13.5	10	40	12
28	54	31	57	6	25	15	10	45	12
30	54	33	57	6	25	15	10	45	12
32	54	35	57	6	25	15	10	47	12
35	60	38	63	7	26	16	10	52	12
38	65	41	68	9	30	18	12	53	14
40	65	43	68	9	30	18	12	53	14
45	70	48	73	9	32	20	12	58	14
50	85	53	88	11	39.5	24.5	15	68	16
55	85	53	88	11	39.5	24.5	15	68	16
60	105	65	110	12	45	30	15	87	20
65	105	70	110	13	45	30	15	87	20
70	105	75	110	13	45	30	15	90	20

Elastomere bellows seals